

Last information update: April 2024



Product code

MWG2: Installation clips kit

Technical description

kit for securely fixing flexible strips; the pack contains 10 clips made of plastic, easily applied to surfaces

Installation

fix the clips to the surface using screws (not included); fast, secure, reusable strip locking system

Colour

White (01)

Weight (Kg)

0

Complies with EN60598-1 and pertinent regulations

Last information update: April 2024



Product code
MWG1: Rigid aluminum channel

Technical description
kit for securely fixing the flexible strips; the pack contains 5 rigid supports made of aluminium profiles 1000 mm long, with steel clips for fixing to surfaces and plastic fasteners for securing the strips on the profiles

Installation
fix the steel clips (screws not included) to the surface then insert the profiles; the strip inserted along the profiles is locked in position by the snap-on fasteners supplied

Colour
Aluminium (12)

Weight (Kg)
0.61

Complies with EN60598-1 and pertinent regulations

Underscore18

Last information update: April 2024



Product code
MXR0: Translucent diffuser screen - L = 2000 for RGB versions

Technical description
Specific translucent polycarbonate diffuser screen for Underscore profiles for RGB Ledstrip.

Installation
snap-in on profile

Colour
Clear and satin (21)

Weight (Kg)
0.07

Complies with EN60598-1 and pertinent regulations

Last information update: April 2024



Product code
MXQ9: Opal diffuser screen - L = 2000 for RGB versions

Technical description
Specific opal polycarbonate diffuser screen for Underscore profiles for RGB Ledstrip. The diffuser finish, combined with the high profiles, softens the pinpoint effect typical of strips.

Installation
snap-in on profile

Colour	Weight (Kg)
Opaline (38)	0.07

Complies with EN60598-1 and pertinent regulations

Last information update: September 2024

Product configuration: M253+LENGTH1

M253: flexible strip - 5m - 12V LED 1

LENGTH1: Length 1m - 1m

**Product code**

M253: flexible strip - 5m - 12V LED 1

Technical description

Product for linear lighting - with RGB LEDs - made on a white flexible circuit coated with a layer of silicone; the silicone protection guarantees IP65 protection for the uncut strip. The ends of the circuits are fitted with connectors with IP20 protection, therefore we recommend that the strips be used indoors. Supplied in 5-metre long coils wound on suitable supports; the pack includes a connections kit for in line or power supply connections. The back of the circuit is coated with adhesive for rapid application; mounting accessories are available for less simple installations. The strip can be cut at a centre-to-centre distance of 100 mm (minimum 3 LEDs); if intermediate cuts are made, ensure that the cut ends are carefully sealed. LED features: RGB full colour - 30 LEDs/m - flare angle 100° - 40W total - power supply 12V - maximum 2 coils can be connected in line with suitable accessory sequencers.

Installation

rapid installation with adhesive; clips are available for added fixing guarantees (code MWG2: 10 pieces) and rigid aluminium supports (code MWG1: 5 pieces x 1m)

Colour
White (01)**Weight (Kg)**
0.21**Mounting**
wall surface**Wiring**

Ballasts and sequencers to be ordered separately. Sequencers: PWM master model with radio control (code MWF9 for max. 2 RGB strips in line); PWM model without radio control (code MWG0 for max. 2 RGB strips in line). Using MWF9 - master - it is possible to join 2 strips for each MWG0 - slave - in a continuous sequence; in this case it is important to calculate the total power of the installation (for the power supply), considering that by using the sequencers the power of each strip is reduced to 1/3 (~15W)

Notes

The connectors grant an IP20 protection, for this reason it is advised the use of strips in internal installations. in case of cuts to the strips it is necessary to restore the sealing with accuracy after having done the connection weldings.

Complies with EN60598-1 and pertinent regulations

**Technical data**

lm system:	185	Colour temperature [K]:	RGB
W system:	7.2	Life Time LED 1:	40,000h - L70 (Ta 25°C)
lm source:	185	Voltage [Vin]:	12
W source:	7.2	Lamp code:	LED
Luminous efficiency (lm/W, real value):	25.7	Number of lamps for optical assembly:	1
lm in emergency mode:	-	ZVEI Code:	LED
Total light flux at or above an angle of 90° [Lm]:	4	Number of optical assemblies:	1
Light Output Ratio (L.O.R.) [%]:	100		

Polar

Imax=54 cd		Lux			
90°	180°	90°	h	d	Em Emax
			1	3.9	29 54
			2	7.9	7 13
			3	11.8	3 6
			4	15.7	2 3
$\alpha = 126^\circ$					

Isolux

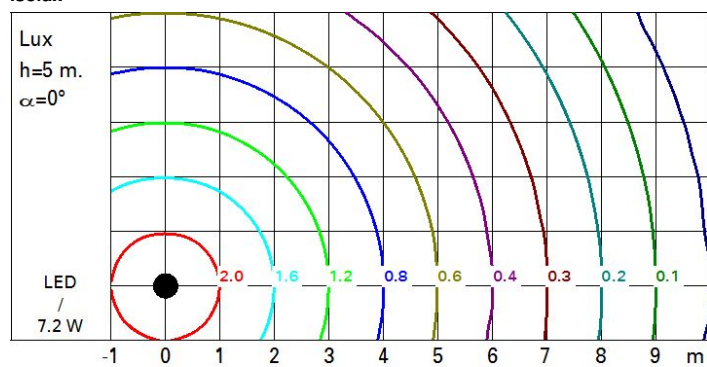

Last information update: September 2024

Product configuration: M829+LENGTH1

M829: tira flexible- 5m - 12V LED 1

LENGTH1: Length 1m - 1m

**Product code**

M829: tira flexible- 5m - 12V LED 1

Technical description

Product for linear lighting - with RGB LEDs - made on a white flexible circuit coated with a layer of silicone; the silicone protection guarantees IP65 protection for the uncut strip. The ends of the circuits are fitted with connectors with IP20 protection, therefore we recommend that the strips be used indoors. Supplied in 5-metre long coils wound on suitable supports; the pack includes a connections kit for in line or power supply connections. The back of the circuit is coated with adhesive for rapid application; mounting accessories are available for less simple installations. The strip can be cut at a centre-to-centre distance of 100 mm (minimum 3 LEDs); if intermediate cuts are made, ensure that the cut ends are carefully sealed. LED features: RGB full colour - 30 LEDs/m - flare angle 100° - 40W total - power supply 12V - maximum 2 coils can be connected in line with suitable accessory sequencers.

Installation

rapid installation with adhesive; clips are available for added fixing guarantees (code MWG2: 10 pieces) and rigid aluminium supports (code MWG1: 5 pieces x 1m)

Colour
White (01)**Weight (Kg)**
0.18**Mounting**
wall surface**Wiring**

Ballasts and sequencers to be ordered separately. Sequencers: PWM master model with radio control (code MWF9 for max. 2 RGB strips in line); PWM model without radio control (code MWG0 for max. 2 RGB strips in line). Using MWF9 - master - it is possible to join 2 strips for each MWG0 - slave - in a continuous sequence; in this case it is important to calculate the total power of the installation (for the power supply), considering that by using the sequencers the power of each strip is reduced to 1/3 (~15W)

Notes

The connectors grant an IP20 protection, for this reason it is advised the use of strips in internal installations. in case of cuts to the strips it is necessary to restore the sealing with accuracy after having done the connection weldings.

Complies with EN60598-1 and pertinent regulations

**Technical data**

lm system:	185	Colour temperature [K]:	RGB
W system:	7.2	Life Time LED 1:	40,000h - L70 (Ta 25°C)
lm source:	185	Voltage [Vin]:	12
W source:	7.2	Lamp code:	LED
Luminous efficiency (lm/W, real value):	25.7	Number of lamps for optical assembly:	1
lm in emergency mode:	-	ZVEI Code:	LED
Total light flux at or above an angle of 90° [Lm]:	8	Number of optical assemblies:	1
Light Output Ratio (L.O.R.) [%]:	100	Intervalllo temperatura ambiente:	from -20°C to +35°C.

Polar

Imax=59 cd		Lux			
90°	180°	90°	h	d	Em Emax
			1	3.3	34 59
			2	6.7	8 15
			3	10	4 7
			4	13.3	2 4
$\alpha = 118^\circ$					

Isolux

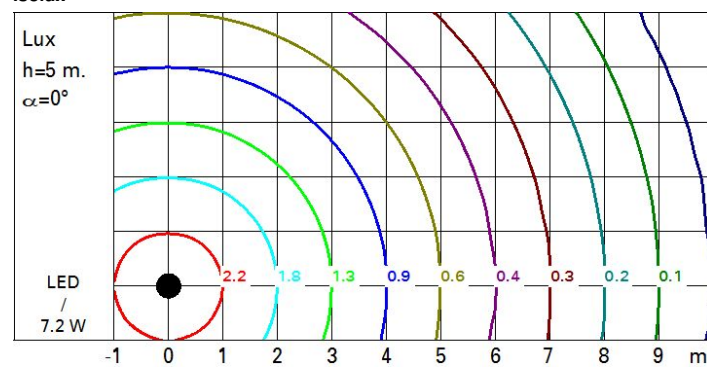

Last information update: September 2024

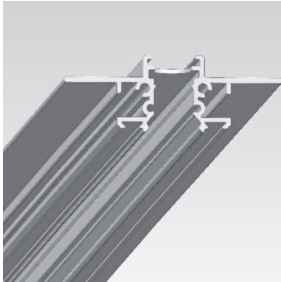
**Product code**

MXQ4: High recessed linear Minimal profile for Ledstrip Top RGB versions - L=2000

Technical description

Rigid aluminium profile designed for fully recessed installation, insertable in 12.5 mm thick false ceilings. Ideal for minimal lines of lighting flush with the ceiling without borders (after filling and finishing). The shape of the profile allows application of all RGB Ledstrips with front emission LEDs, available in standard version (with adhesive) or tube version (with outer sheath). The profile may be completed with a diffuser screen available with two finishes: opal and translucid. The raised section of the profile, coupled with the opal diffuser screen, eliminates the pinpoint effect typical of strips.

Installation

recessed in milled parts; profile fixed on false ceiling using screws (not included); filling, finishing and painting are required for a smooth, even profile opening onto the ceiling. Accessory closing end caps (code MXQ8 - kit 4 pcs).

Colour

Indeterminate (00)

Weight (Kg)

0.61

Mounting

wall recessed|ceiling recessed|ceiling surface

Wiring

Carefully read the Ledstrip instructions sheet

Notes

Carefully read the Ledstrip instructions sheet

Complies with EN60598-1 and pertinent regulations

850°C

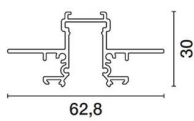

Last information update: April 2024



Product code
MXQ9: Opal diffuser screen - L = 2000 for RGB versions

Technical description
Specific opal polycarbonate diffuser screen for Underscore profiles for RGB Ledstrip. The diffuser finish, combined with the high profiles, softens the pinpoint effect typical of strips.

Installation
snap-in on profile

Colour	Weight (Kg)
Opaline (38)	0.07

Complies with EN60598-1 and pertinent regulations

Last information update: September 2024

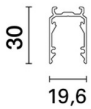
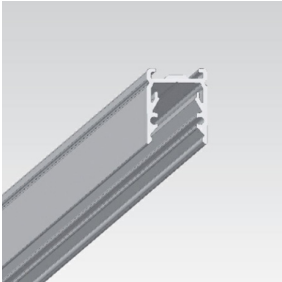

Product code

MXQ3: High surface linear profile for Ledstrip Top RGB versions - L=2000

Technical description

Rigid frameless aluminium profile for surface installation (high version); the shape of the profile allows application of all RGB Ledstrips with front emission LEDs, available in standard version (with adhesive) or tube version (with outer sheath). Finishes available: anodised grey - white. The profile may be completed with a diffuser screen available with two finishes: opal and translucent. The raised section of the profile, coupled with the opal diffuser screen, eliminates the pinpoint effect typical of strips.

Installation

surface-mounted; direct fixing with screws (not included); the profile has a longitudinal guide to facilitate drilling. For challenging installations, a kit of accessory clips is available (code MXM4 x 5 pcs); with preliminary fixing of the clips using screws, then profile snap-in anchoring on the clips prepared (screws not included). Accessory closing end caps (code MXQ6 - kit 2 x 5 pcs).

Colour

White (01) | Aluminium (12)

Weight (Kg)

0.67

Mounting

wall surface|ceiling surface

Wiring

Carefully read the Ledstrip instructions sheet

Notes

Carefully read the Ledstrip instructions sheet

Complies with EN60598-1 and pertinent regulations

850°C

Underscore18

Last information update: April 2024



Product code
MXR0: Translucent diffuser screen - L = 2000 for RGB versions

Technical description
Specific translucent polycarbonate diffuser screen for Underscore profiles for RGB Ledstrip.

Installation
snap-in on profile

Colour
Clear and satin (21)

Weight (Kg)
0.07

Complies with EN60598-1 and pertinent regulations

Last information update: April 2024



Product code
MXQ9: Opal diffuser screen - L = 2000 for RGB versions

Technical description
Specific opal polycarbonate diffuser screen for Underscore profiles for RGB Ledstrip. The diffuser finish, combined with the high profiles, softens the pinpoint effect typical of strips.

Installation
snap-in on profile

Colour	Weight (Kg)
Opaline (38)	0.07

Complies with EN60598-1 and pertinent regulations

Last information update: September 2024

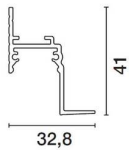
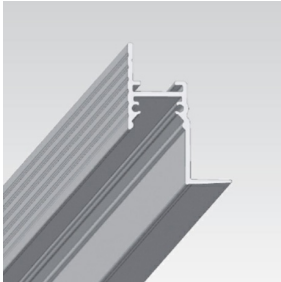
**Product code**

MXQ5: Perimeter linear profile for Ledstrip Top RGB versions - L=2000

Technical description

Specific rigid aluminium profile for perimetric lighting effects. Ideal for cove-lighting along the perimeter of rooms. Combined with plasterboard panels, allows lines of surface-skimming or direct lighting between the ceiling and the wall or close to the floor. The profile is designed to obtain lines flush with the ceiling, without borders (after filling and finishing), concealing the strip inside the recess (cut-off angle 45°). The profile allows application of all RGB Ledstrips with front emission LEDs, available in standard version (with adhesive) or tube version (with outer sheath). Diffuser screens available to complete the unit, with two finishes: opal and translucent.

Installation

Linear perimetric ceiling cove-lighting for surface-skimming lighting on the wall - linear ceiling cove-lighting for direct lighting on the wall or surface-skimming lighting on the ceiling - linear perimetric wall cove-lighting for surface-skimming lighting on the wall close to the floor. Profile fixing to the ceiling/wall using screws (not included); the panels combined with the profile (recommended thickness 12.5 mm) must be fixed using suitable structures: the profile is not load-bearing. Accessory closing end caps (code MXQ7 - kit 2 x 5 pcs).

Colour

Indeterminate (00)

Weight (Kg)

0.74

Mounting

ceiling recessed/ceiling surface

Wiring

Carefully read the Ledstrip instructions sheet

Notes

Carefully read the Ledstrip instructions sheet

Complies with EN60598-1 and pertinent regulations

850°C

Last information update: September 2024

Product configuration: M829+LENGTH1

M829: tira flexible- 5m - 12V LED 1

LENGTH1: Length 1m - 1m

**Product code**

M829: tira flexible- 5m - 12V LED 1

Technical description

Product for linear lighting - with RGB LEDs - made on a white flexible circuit coated with a layer of silicone; the silicone protection guarantees IP65 protection for the uncut strip. The ends of the circuits are fitted with connectors with IP20 protection, therefore we recommend that the strips be used indoors. Supplied in 5-metre long coils wound on suitable supports; the pack includes a connections kit for in line or power supply connections. The back of the circuit is coated with adhesive for rapid application; mounting accessories are available for less simple installations. The strip can be cut at a centre-to-centre distance of 100 mm (minimum 3 LEDs); if intermediate cuts are made, ensure that the cut ends are carefully sealed. LED features: RGB full colour - 30 LEDs/m - flare angle 100° - 40W total - power supply 12V - maximum 2 coils can be connected in line with suitable accessory sequencers.

Installation

rapid installation with adhesive; clips are available for added fixing guarantees (code MWG2: 10 pieces) and rigid aluminium supports (code MWG1: 5 pieces x 1m)

Colour
White (01)**Weight (Kg)**
0.18**Mounting**
wall surface**Wiring**

Ballasts and sequencers to be ordered separately. Sequencers: PWM master model with radio control (code MWF9 for max. 2 RGB strips in line); PWM model without radio control (code MWG0 for max. 2 RGB strips in line). Using MWF9 - master - it is possible to join 2 strips for each MWG0 - slave - in a continuous sequence; in this case it is important to calculate the total power of the installation (for the power supply), considering that by using the sequencers the power of each strip is reduced to 1/3 (~15W)

Notes

The connectors grant an IP20 protection, for this reason it is advised the use of strips in internal installations. in case of cuts to the strips it is necessary to restore the sealing with accuracy after having done the connection weldings.

Complies with EN60598-1 and pertinent regulations

**Technical data**

Im system:	185	Colour temperature [K]:	RGB
W system:	7.2	Life Time LED 1:	40,000h - L70 (Ta 25°C)
Im source:	185	Voltage [Vin]:	12
W source:	7.2	Lamp code:	LED
Luminous efficiency (lm/W, real value):	25.7	Number of lamps for optical assembly:	1
Im in emergency mode:	-	ZVEI Code:	LED
Total light flux at or above an angle of 90° [Lm]:	8	Number of optical assemblies:	1
Light Output Ratio (L.O.R.) [%]:	100	Intervalllo temperatura ambiente:	from -20°C to +35°C.

Polar

Imax=59 cd		Lux			
90°	180°	90°	h	d	Em Emax
			1	3.3	34 59
			2	6.7	8 15
			3	10	4 7
			4	13.3	2 4
$\alpha = 118^\circ$					

Isolux

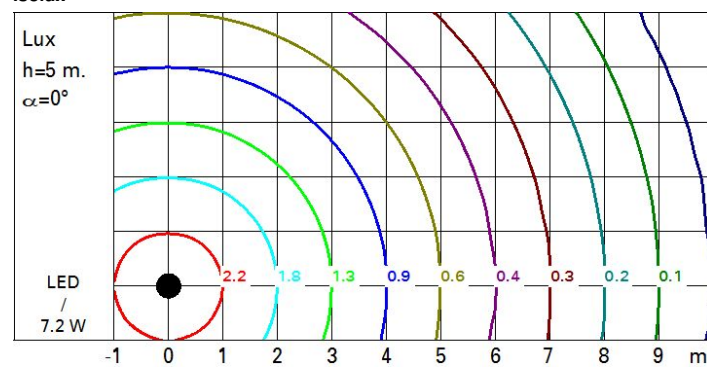

Last information update: September 2024

Product configuration: M253+LENGTH1

M253: flexible strip - 5m - 12V LED 1

LENGTH1: Length 1m - 1m

**Product code**

M253: flexible strip - 5m - 12V LED 1

Technical description

Product for linear lighting - with RGB LEDs - made on a white flexible circuit coated with a layer of silicone; the silicone protection guarantees IP65 protection for the uncut strip. The ends of the circuits are fitted with connectors with IP20 protection, therefore we recommend that the strips be used indoors. Supplied in 5-metre long coils wound on suitable supports; the pack includes a connections kit for in line or power supply connections. The back of the circuit is coated with adhesive for rapid application; mounting accessories are available for less simple installations. The strip can be cut at a centre-to-centre distance of 100 mm (minimum 3 LEDs); if intermediate cuts are made, ensure that the cut ends are carefully sealed. LED features: RGB full colour - 30 LEDs/m - flare angle 100° - 40W total - power supply 12V - maximum 2 coils can be connected in line with suitable accessory sequencers.

Installation

rapid installation with adhesive; clips are available for added fixing guarantees (code MWG2: 10 pieces) and rigid aluminium supports (code MWG1: 5 pieces x 1m)

Colour
White (01)**Weight (Kg)**
0.21**Mounting**
wall surface**Wiring**

Ballasts and sequencers to be ordered separately. Sequencers: PWM master model with radio control (code MWF9 for max. 2 RGB strips in line); PWM model without radio control (code MWG0 for max. 2 RGB strips in line). Using MWF9 - master - it is possible to join 2 strips for each MWG0 - slave - in a continuous sequence; in this case it is important to calculate the total power of the installation (for the power supply), considering that by using the sequencers the power of each strip is reduced to 1/3 (~15W)

Notes

The connectors grant an IP20 protection, for this reason it is advised the use of strips in internal installations. in case of cuts to the strips it is necessary to restore the sealing with accuracy after having done the connection weldings.

Complies with EN60598-1 and pertinent regulations

**Technical data**

Im system:	185	Colour temperature [K]:	RGB
W system:	7.2	Life Time LED 1:	40,000h - L70 (Ta 25°C)
Im source:	185	Voltage [Vin]:	12
W source:	7.2	Lamp code:	LED
Luminous efficiency (Im/W, real value):	25.7	Number of lamps for optical assembly:	1
Im in emergency mode:	-	ZVEI Code:	LED
Total light flux at or above an angle of 90° [Lm]:	4	Number of optical assemblies:	1
Light Output Ratio (L.O.R.) [%]:	100		

Polar

Imax=54 cd		Lux			
90°	180°	90°	h	d	Em Emax
			1	3.9	29 54
			2	7.9	7 13
			3	11.8	3 6
			4	15.7	2 3
$\alpha = 126^\circ$					

Isolux

